

Wipe Tests – R/V Point Sur

Collection:

Initial wipe tests must be done immediately on boarding, prior to set up. Final wipe tests should be done after the rad area has been packed up and cleaned. Use the map below as a guideline for where to do the wipe tests:

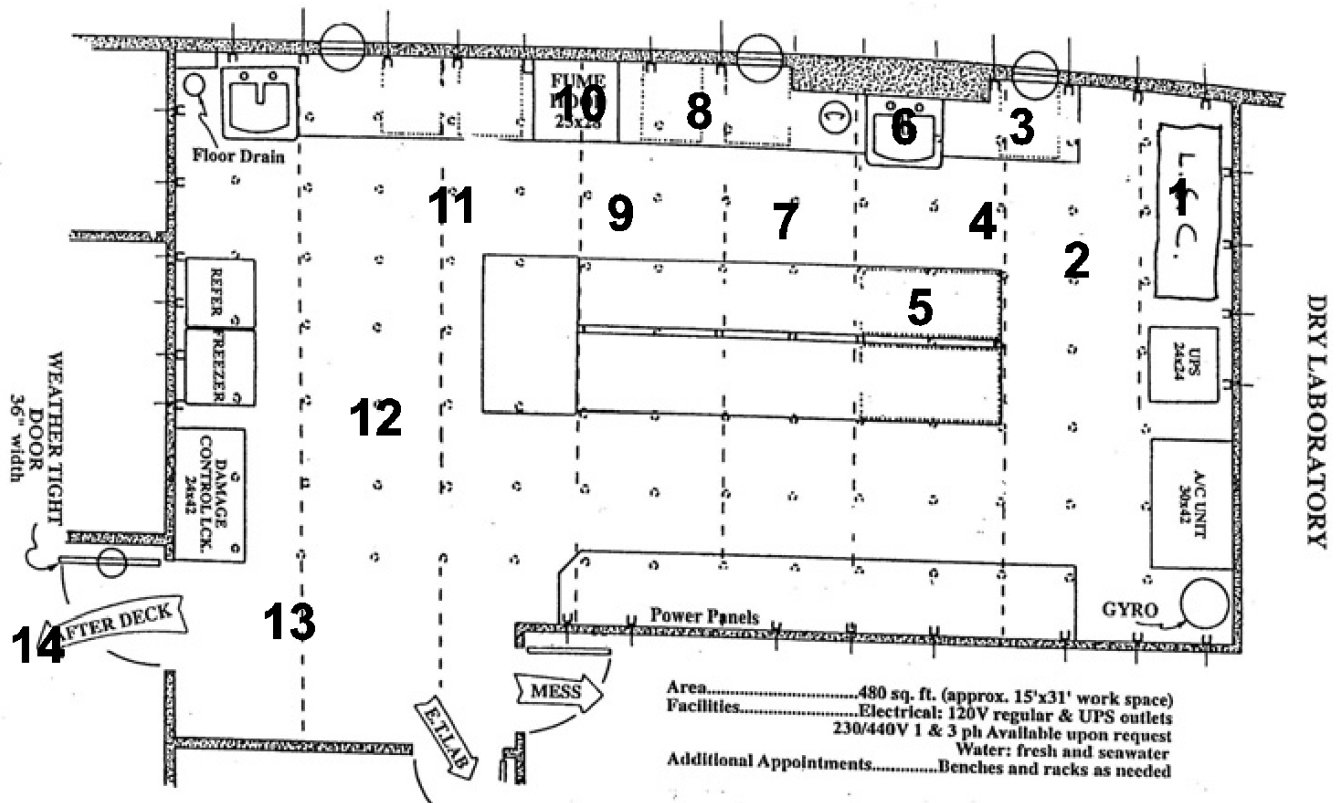

15, 16, 17, 18, 19 and 20 are collected over deck areas and wet lab en route to and around the incubator on the aft deck.

Use a glove or forceps to handle GF/F filters. Wipe a filter over the area and place in a glass scintillation vial labeled with the corresponding number. After collecting all 20 filters, add 10ml of scintillation cocktail to the vial and shake vigorously. Make 2 fluor blanks (10ml cocktail only) and 2 filter blanks (10ml cocktail + blank filter). Place all 24 vials in racks in counter and count using the USER 1 swipe test protocol. Check with the ET for the USER 1 id card and scintillation counter operation.

Before leaving the ship, give the ET a copy of the map, initial counts and final counts. Keep a copy for yourself and make a third copy for UCSB radiation safety. Karina Rizzo & Mike Lemmon are the UCSB contact – x7255 & x7256, respectively (Karina cell is (805) 350-3067). Jim Casto is X3588 or cell phone (805) 680-2118. Radiation safety transports the ¹⁴C samples and all waste (dry and liquid) back to campus, be sure to call them the day before you dock to give them the ETA. If there are any itinerary changes, be sure to call and update them.